

**Crown Land (Reserves) Act 1978**

**ORDER GIVING APPROVAL TO GRANT A LEASE UNDER SECTIONS 17D AND 17DA**

Under section 17D and 17DA of the *Crown Land (Reserves) Act 1978* I, Lily D'Ambrosio MP, Minister for Energy, Environment and Climate Change, being satisfied that there are special reasons which make the granting of a lease reasonable and appropriate in the particular circumstances and to do this will not be substantially detrimental to the use and enjoyment of any adjacent land reserved under the *Crown Land (Reserves) Act 1978*, approve the granting of a lease by the Port Phillip City Council as committee of management over the Gasworks Park Reserve described in the schedule below for arts related purposes and, in accordance with section 17D(3)(a) of the *Crown Land (Reserves) Act 1978*, state that:

- (a) there are special reasons which make granting of a lease reasonable and appropriate in the particular circumstances; and
- (b) to do this will not be substantially detrimental to the use and enjoyment of any adjacent land reserved under the *Crown Land (Reserves) Act 1978*.

**SCHEDULE**

The land, being the land shown shaded and coloured black on the attached plan, which is part of the Crown land deemed temporarily reserved for the purposes of recreation and public park at South Melbourne, Parish of South Melbourne under section 5 of the *Crown Land (Reserves) Act 1978*.

1204562



**LILY D'AMBROSIO MP**

**Minister for Energy, Environment and Climate Change**

Dated: 18 / 06 / 2020

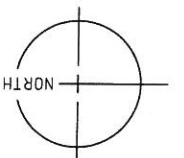
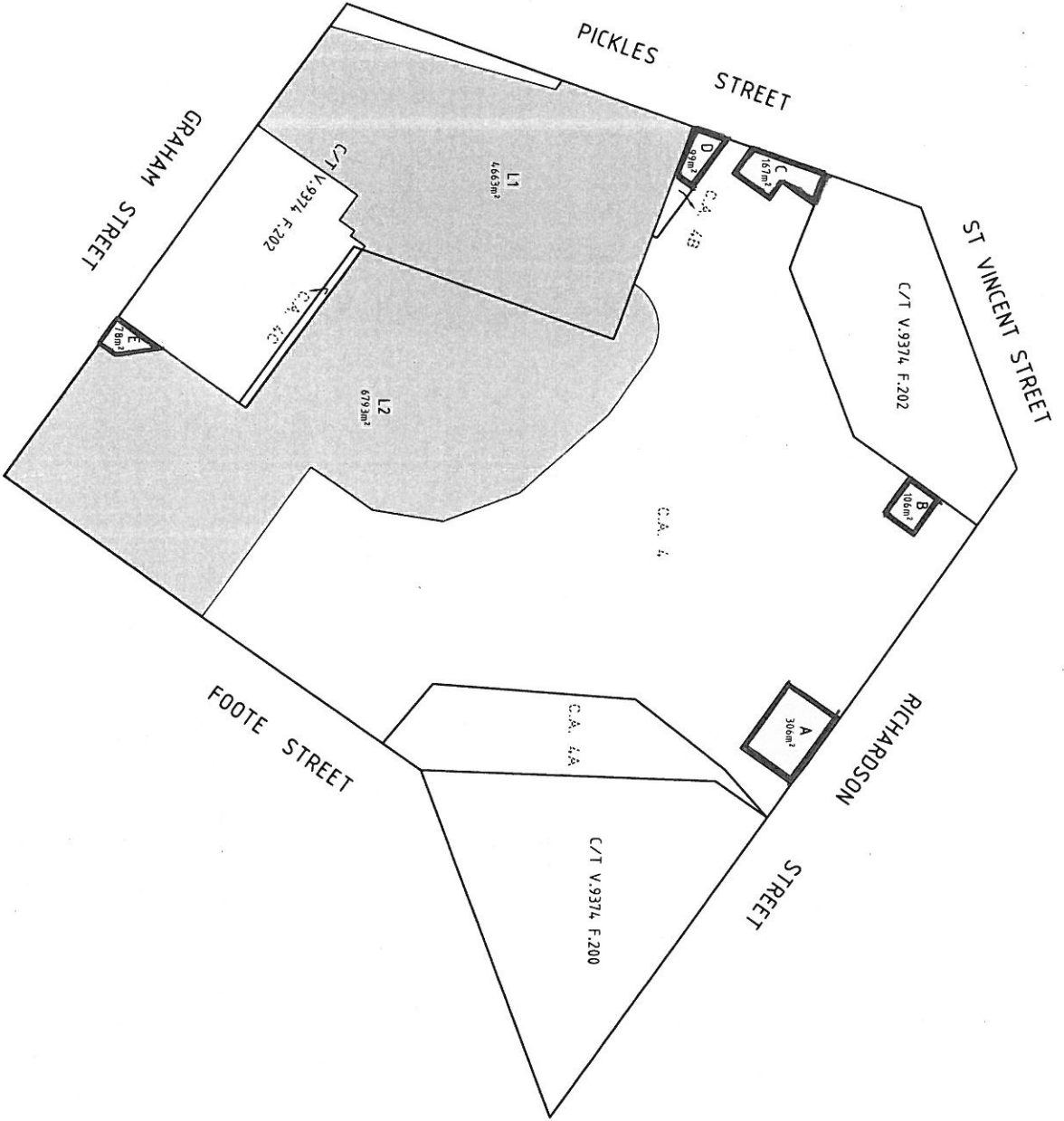

MG49, ZONE 55

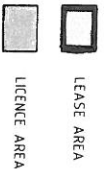

- FOR DETAILS SEE DRAWING:
- L1 - 1600893\_LICENCE-1.DWG
  - L2 - 1600893\_LICENCE-2.DWG
  - A - 1600893\_LEASE-A.DWG
  - B - 1600893\_LEASE-B.DWG
  - C - 1600893\_LEASE-C.DWG
  - D - 1600893\_LEASE-D.DWG
  - E - 1600893\_LEASE-E.DWG

CLIENT: CITY OF PORT PHILLIP

DETAILS: LEASE & LICENCE AREA SURVEY

PROJECT: GASWORKS RESERVE GRAHAM STREET ALBERT PARK

**Beveridge Williams**  
development & environment consultants  
Melbourne ph. 03 9524 8888

SURVEYORS REF: 1600893  
VERSION 2  
DATE: SEPTEMBER 2016  
SHEET 1 OF 1

SCALE: 1:800  
SHEET SIZE: A2  
LENGTHS ARE IN METRES

SURVEYOR: J.V.  
DRAWN: J.V.  
CHECKED: S.M.  
MELWAYS REF: 57 D-4

CAO REFERENCE: K:\08501\A\...\1600893-HAS1FER.dwg

VER	BY	AMENDMENTS	DATE
A			
B			
C			
D			
E			